

# New Student Enrollment Guide

---

NORTHLAND  
COLLEGE

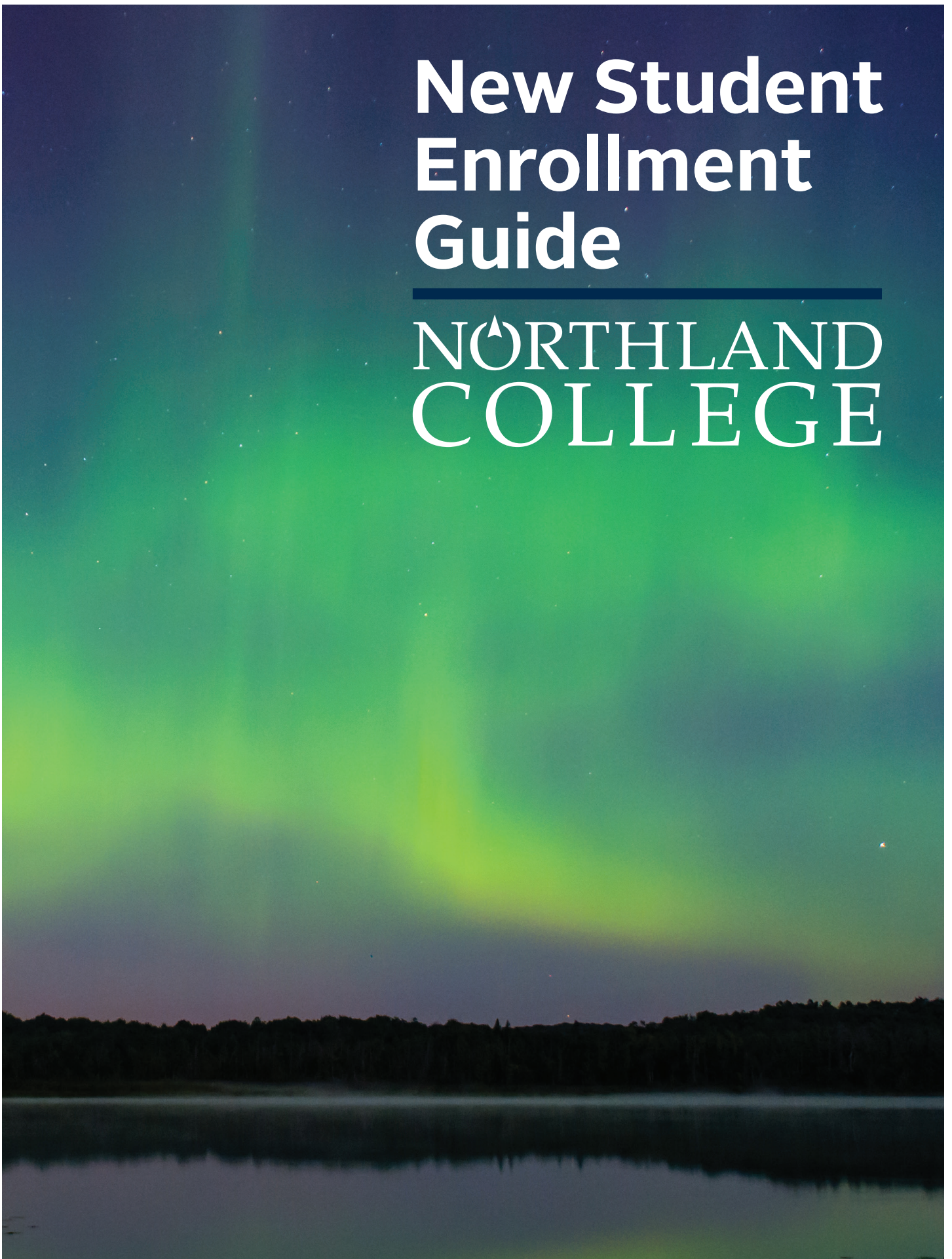



# What to Do Next

This guide is designed to help set you up for a successful start to your time at Northland.

There's a lot of important information here, so please read through carefully and keep it for reference during your first year.







## Welcome to the Northland Community!

We're so excited to have you joining us this year and can't wait to get to know you! This guide is meant to help you navigate your way to campus and throughout your first year. As you have questions please be sure to connect with your admissions counselor. They're here to help and will be sure to send updates on everything from the checklist to orientation as they've got them!

As you begin your time at Northland there will be lots of great resources for you to help and support you throughout your time on campus. One of those resources is your academic advisor. Read on to learn more about what they do and how they can support you!

## Your Academic Advisor

You'll be assigned a dedicated advisor who will meet with you in person every semester. Your advisor can help you create an academic plan, provide advice on courses prior to registration for the semester, and help you with the ins and outs of navigating college academics. They'll have insight on what to expect from different classes, what courseload will look like, and when you should take different courses.

Academic advisors are trained faculty and staff members, and every effort is made to match you with one in your area of interest.

## Three Tips for Academic Success



Make a plan. You can start by learning about the requirements for a degree ([my.northland.edu/requirements](https://my.northland.edu/requirements)) and by having regular appointments with your advisor to make sure you're on track.



Expect to spend more time outside the classroom on homework than you may be used to. In general, you can expect to spend two hours studying outside the classroom for every hour spent in the classroom.



Seek help early if you are struggling! Tutors, faculty office hours, and academic support are always available to help! There are plenty of resources to help you be successful throughout your time at Northland.





The independence of college can be exhilarating, but it can also be overwhelming. If you feel overwhelmed, personally or academically, remember that everyone at Northland is here for you in one way or another—and there are certain people you can go to for certain things.

### Personal Support

- **Campus Counselor:** The counselor is available for short-term counseling, as well as crisis management and off-campus referral. All services are free. The counselor's office is located on the second floor of the Ponzio Campus Center.
- **Health Center:** Staffed by a registered nurse, the Health Center is open for basic health services. It's located on the second floor of the Ponzio Campus Center.
- **Accommodations Office:** This office is here to provide support for temporary or permanent physical, health, learning, sensory, or psychological disabilities.
- **Diversity and Inclusion Coordinator:** The diversity and inclusion coordinator is available to support and advocate for students of diverse backgrounds as well as their families.
- **Residence Life Staff:** Each residence hall has one head resident assistant and a team of resident assistants who organize programming and serve as a resource and guide for their students.

### Academic Support

- **Course Instructors:** Instructors want to hear from you and can provide valuable information on how you can succeed in their course. Look for office hour information on your course syllabus.
- **Teaching Assistants:** Some courses have student-teaching assistants. They have taken the course before and can help you understand the content.
- **Tutors:** Free tutoring is available in most subjects. You can find tutoring schedules online
- **Advisors:** Your advisor will be paired with you over the summer before you arrive to campus. They'll connect with you each semester before registration to make sure you're on track for your major and minor. They are great people to connect with on what to expect from your classes, workload, and to help plan for a successful semester.
- **Academic Success Coordinator:** If you need extra help with time management and study skills, contact the academic success coordinator for one-on-one sessions.



# First Steps

---

## Enrollment Checklist

You can access your enrollment checklist by logging onto **[applynow.northland.edu/apply/status](https://applynow.northland.edu/apply/status)** using the email and password you used when applying. If you applied using the Common Application, contact your admissions representative to create a login.

On the checklist you'll find all the forms you need to complete before arriving on campus in August. When viewing this online, items in orange are available. Clicking on the item will take you to the appropriate form.

☐ **Registration Disclosure Agreement**

This form must be completed to help facilitate any future credit needs.

☐ **FERPA Acknowledgment Form**

The Family Educational Rights and Privacy Act of 1974 (FERPA) protects the privacy of student records. Under FERPA, students must give written permission for Northland College to release information to anyone other than the student.

☐ **Media Release**

This grants Northland media and photo permission for promotional use.

☐ **Writing Assessment**

You must complete the writing assessment before your fall course registration appointment.

☐ **Outdoor Orientation Registration Forms**

☐ **Health Questionnaire**

☐ **Physician Examination Form**

☐ **Fall Course Registration Appointment**

Sign up for a registration appointment. The appointment can be in person or over the phone, and usually takes no more than thirty minutes.

☐ **Housing Survey**

This form collects information about your life and study habits for roommate matching purposes.

☐ **Housing and Meal Plan Agreement**

Select your meal plan and confirm that you've reviewed and agreed to Northland's basic student policies.

# Connecting to Campus

---

After your enrollment deposit fee has been processed, you'll receive an email from Northland College Computing with the subject line: "Getting started with my.northland.edu."

That email has your login information for important pages within the campus website, **[my.northland.edu](https://my.northland.edu)**. Make sure you follow the instructions in the email and verify your student account.

Here are some of the basic things you can do:

- Accept or decline your financial aid
- Pay your bill
- See which courses you're registered for
- Search for required textbooks
- Search for a work-study job

Want to dig into the details? Find out about orientation, registration, housing, billing, and more at **[my.northland.edu/incoming-students](https://my.northland.edu/incoming-students)**

## Important Summer Dates

---

### Check Out Your Enrollment Checklist For More Important Dates Online!

#### July

**15** • Fall tuition bills go out - keep an eye out in the mail!

#### August

**15** • Fall tuition bills are due - be sure to connect with your admissions counselor about questions and to get connected with the billing team.

#### September

**6** • Classes begin!



# Orientation

---

## Outdoor Orientation

Outdoor Orientation has been a signature Northland program for almost fifty years.

How does it work? Basically, you can take a trip into the local region with a small group of peers for a few days of outdoor recreation and relaxation.

Each trip is built around activities like canoeing, climbing, and trail stewardship. As part of the enrollment process, you'll sign up for a trip that sounds appealing to you. The trips are designed to accommodate any experience level. Your guides are friendly, well-trained, current students.

By the time you get back from your trip, you'll have developed a stronger sense of place, bonded with your fellow students, and built up confidence as you prepare for your first semester.

## Welcome Week

Welcome week is required for all incoming students. This week brings everyone together, as a class, for a focused introduction to Northland's campus and community with a variety of different events. From visiting scenic Chequamegon bay sites to meeting faculty and staff the week will be packed with great adventures and time to get to know Northland and the surrounding Ashland community.

## Moving In

---

Once you've registered for an Outdoor Orientation trip and/or welcome week you'll know your arrival day.

This is when you'll move everything into your room with the help of faculty, staff, and current students. There will be plenty of help around during arrival to get you settled into your space and residential hall community. Once you're moved in, you'll begin the rest of the orientation experience.





# What to Pack

---

Here are guidelines and helpful tips on what to pack for your first year on campus:

## Essential

- ☐ Bedding: twin extra-long sheets (36 x 80), blankets, comforter, pillows
- ☐ Basic clothes: shirts, pants, socks, underwear, etc.
- ☐ Good outerwear: coats, gloves, boots, wool socks, a winter hat, and a scarf
- ☐ Shower supplies: shower caddy, shower shoes, etc.
- ☐ Health and hygiene items: toothbrush, toothpaste, deodorant, body wash, shampoo, Kleenex, hair products, Band-Aids, towels, washcloths, etc.
- ☐ Medications: prescription and over the counter
- ☐ Basic cleaning supplies: broom, disinfectant wipes, etc.
- ☐ Laundry supplies: detergent (consider an environmentally friendly one), a laundry basket or bag, hangers, sewing kit
- ☐ Basic school supplies: pens, pencils, highlighters, scissors, notebooks, flash drive, stapler, backpack, etc.
- ☐ Personal computer or laptop (PC with Windows 7 or higher/Mac with OS X 10.7 or higher)

## Recommended

- ☐ Decorations for your room: plants, rugs, posters, pictures, etc.
- ☐ Tape for hanging decorations
- ☐ Power strip where you can turn everything off
- ☐ Fan (window or standing)
- ☐ Headphones
- ☐ Spoon/fork/plate/bowl: many campus events ask students to bring their own utensils
- ☐ Mug: get a discount in the school store for bringing your own when you get coffee, tea, or hot chocolate!
- ☐ Water bottle
- ☐ Things for fun: a Frisbee, playing cards, hammock, gaming console, bike, etc.

## Totally Optional

- Microwave: one/room, 800 watt or smaller
- Mini-fridge: one/room, 4.3 ft<sup>3</sup> in size or smaller
- Your shoe collection

## Prohibited

- Candles and incense
- Full-size refrigerators
- Double-sided foam tape
- Extension cords or multiple receptacle plugs
- Open-coil cooking devices: hot plates, toasters, etc.
- Appliances that require grease to produce open flame
- Pets, other than fish in an aquarium of ten gallons or less
- Space heaters
- Window air conditioners
- Drones

## Reuse Room

We also have a place on campus called the Reuse Room where other students and community members drop off things they don't want that other people might. You'll find plenty of clothes, books, art supplies, room decorations, dishes, and all sorts of random things you never knew you needed. The best part of all? Everything is free!

## Post Office

If you forget something back home, you can always have it mailed to campus. Located in the Ponzio Campus Center and open daily, the post office allows you to send and receive mail through USPS, UPS, and Fed Ex. You can also buy stamps and other mailings supplies there.

## Example Address:

Student Name CB #1234  
1411 Ellis Ave  
Ashland, WI 54806



# Getting to Know the Bay Area

---

There are so many great outdoor adventure opportunities in our region. If exploring the outdoors is something you'd like to do read the list below! There are more adventure options with Outdoor Pursuits!



## 1 Book Across the Bay

This is a one-of-a-kind race that says so much about our region. Skiers, snowshoers, and walkers follow a course lit by ice candles across Chequamegon Bay at night. Throughout the evening, you will be treated to a fire-breathing dragon, fireworks, chocolate chip cookies, live music, and a roaring bonfire at the finish line.



## 2 Fish on the Brule River

The Brule River—located about forty minutes from campus—is a world-class trout stream surrounded by old growth hemlocks, river trails, and campgrounds. When you're done fishing, grab a canoe and run the rapids.



## 3 Snowboard and Ski in the UP

Michigan's Upper Peninsula is home to ten alpine ski areas. Three are just a short drive from campus. Blackjack Mountain, Big Powderhorn, and Indianhead Mountain offer some of the best downhill terrain and snow conditions in the Midwest. Whitecap Mountain (in Wisconsin) is also nearby and worth the trip.



## 4 Hike the Penokee Mountains

There are a dozen hikes we could recommend, but St Peter's Dome is a student favorite, a summit hike with a phenomenal view of evergreen and conifer forests with a glimpse of Lake Superior. And along the way, check out Morgan and Copper falls.



## 5 Swim in Lake Superior

This region is known for its long stretches of white, sandy beaches. Pack your bathing suit and a picnic and spend sunrise, sunset, or anytime in between at one of the dozen beaches within an hour of campus. You're probably going to want to catch sunset in Cornucopia at some point.



## 6 Bike at Mt. Ashwabay

Bikers head to Mt. Ashwabay—the local ski hill known for its alpine skiing, cross-country ski trails, and miles of single-track mountain bike trails. Have a few days? Rent a yurt, catch a summit view of the sunrise over Lake Superior, and explore biking and XC-trails from a different vantage point.



## 7 Kayak to the Sea Caves

Winter made these sandstone sea caves in the Apostle Islands National Lake Shore an international sensation. But access doesn't stop once the seasons change. Summer means exploration on foot above or on the water by sea kayak.



## 8 Ashland, Washburn, and Bayfield

There are lots of great coffee shops, thrift stores, giftshops and more to visit in the Chequamegon Bay area. Each town has great offerings for a day of in town exploration with movies, games, restaurants and more.



# Fenenga Hall

Living on campus includes lots of great amenities from free laundry and printing to free access to the library, Bay Area Rural Transit bus line and more.

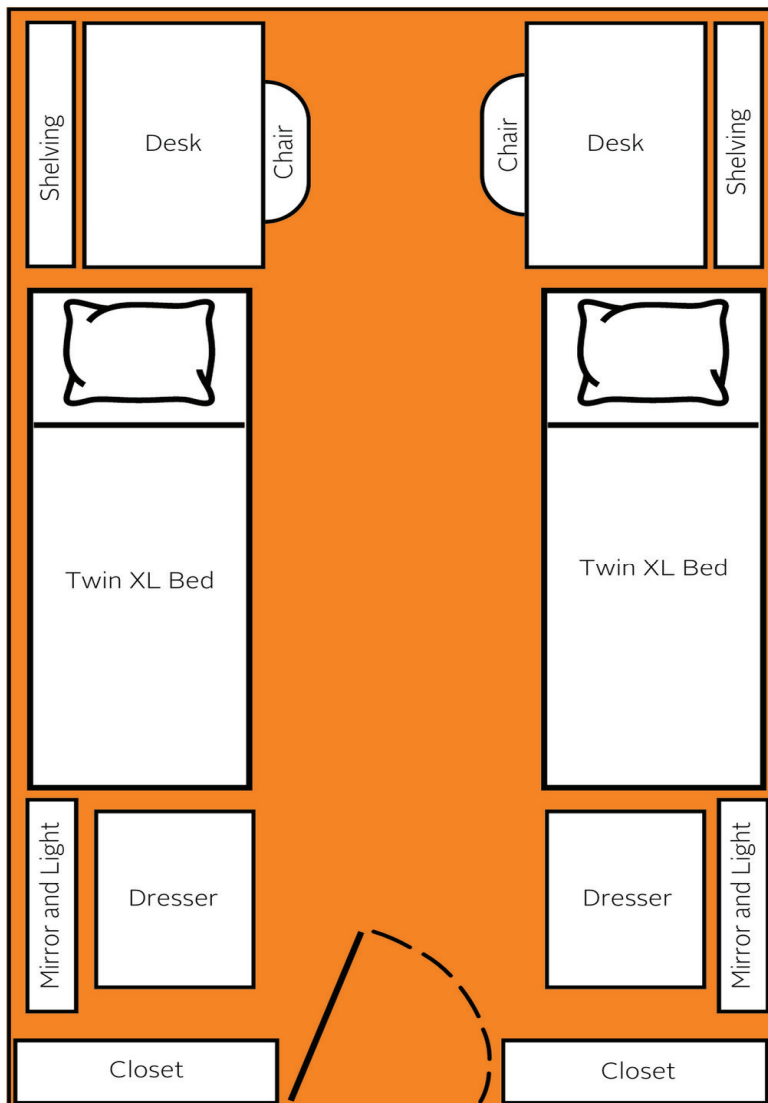

**Gender Inclusive Restroom**



**Free Washer and Dryer Use**



**Full Kitchens Located on 2nd and Ground Floor**



**Free Printing and Community Computers**



**Keycard Accessible Building**



**10 Blocks From Lake Superior**



**Trash, Recycling, and Compost Available**



**Covered Bike, Canoe, and Kayak Storage**



## Room Features

- Room Dimensions: 11'X15
- 2 Beds: Twin XL, 36" X 80"
- 2 Desks: 42" X 29.5"
- 2 Dressers: 24" X 44"
- 2 Individual Closets: 36" X 26" X 85"
- 2 Mirrors
- 2 Built in Shelving Units
- Standard Cable
- Large Window and Window Coverings
- Wifi and Ethernet

## Fenenga Hall Floor Plan

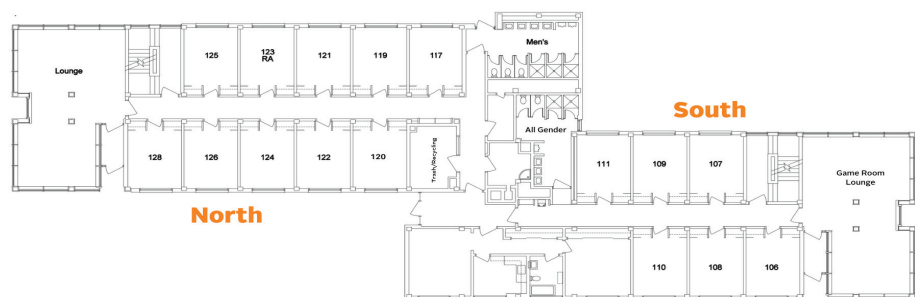



# International Students

For incoming international students the enrollment process is much the same. There are a few extra things admissions will need from you as you begin your trip to Northland!

Adjusting to a whole new country can be hard but we're in it together. This section of the guide is here to help and so are the staff, faculty, and friends here on campus!

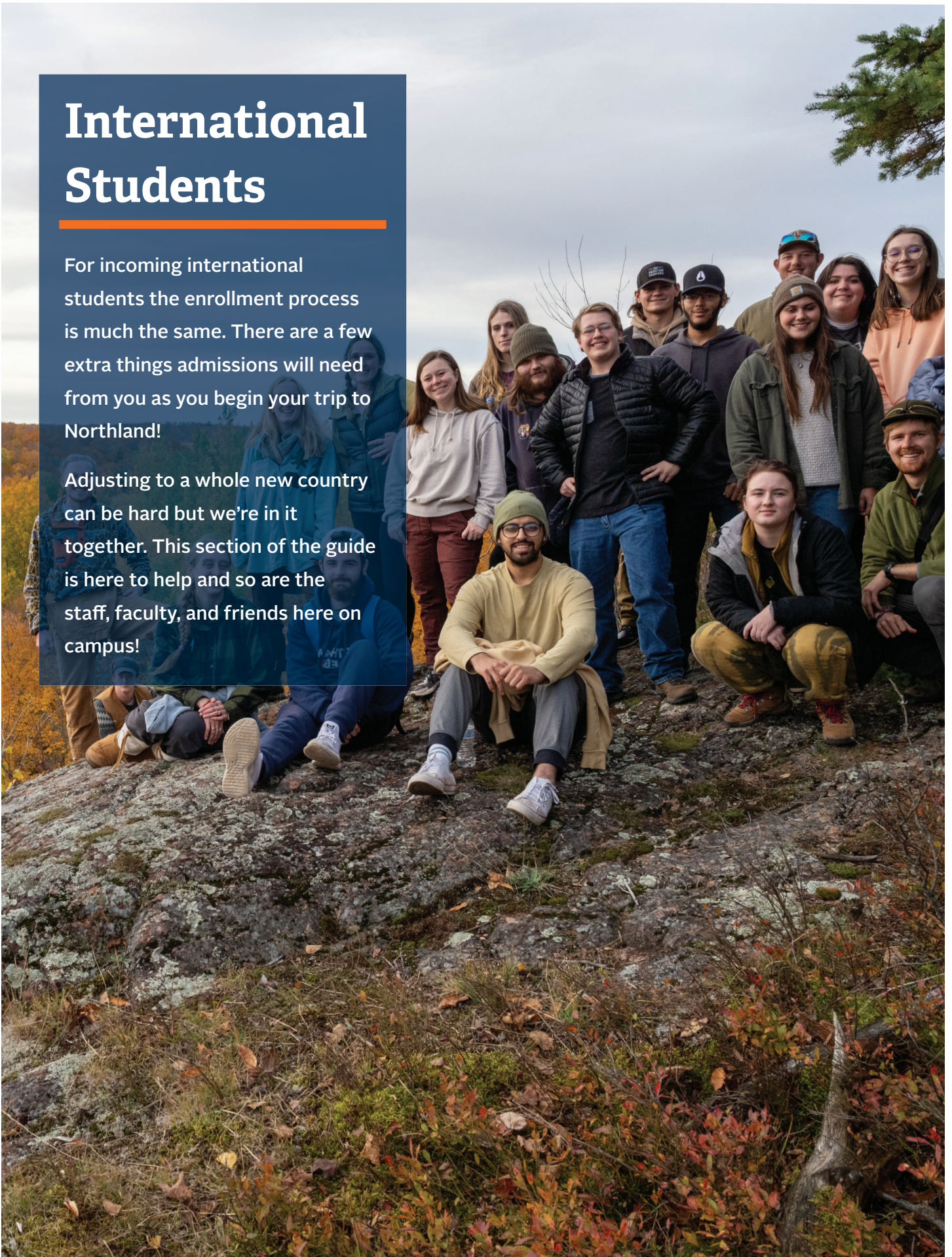





## Your Northland Checklist

Find more on these items in your application portal.

- ☐ Proof of Finances
- ☐ Proof of Embassy Appointment
  - Students from Canada or Bermuda do not need to request an embassy appointment but must bring all required documents to customs when arriving in the United States.
- ☐ Request I-20
- ☐ SEVIS I-901 Fee Proof of Payment
- ☐ Proof of Health Insurance - Due by August 1
- ☐ Proof of Travel Arrangements to United States - Due by August 1

## Someone You Should Know

**Alicia Potvin:** She is your PDSO (Principal Designated School Official) and is who to go to in order to make sure your legal paperwork (I-20) is correct and up to date.

You should definitely see Alicia in Wakefield Hall before leaving the country at any point!

## Using Your Phone in the US

You have two main options when it comes to using your phone in the US.

1. Purchase a SIM card to place in your phone.

The carriers with the best coverage around Northland are either Verizon or AT&T.

Verizon: <https://www.verizon.com/prepaid/>

AT&T: <https://www.att.com/prepaid/plans/>

With this option you can either purchase a SIM card to use in your unlocked phone or you can purchase a phone directly through them. You can order these online or buy them in Ashland once you've arrived.

2. Purchase a Tracfone or a Tracfone plan.

Tracfone <https://www.tracfone.com/activation/selectdevice>

With Tracfone, every phone call, text, and search using data would be charged individually. If you don't plan to use your phone often, this might be an affordable option! If you plan to use your phone frequently, this might not be the best choice for you.



# What to Wear

## Dress for the Weather

Check out more on dressing for winter [here!](#)

- Coat (light for fall, and very warm for winter)
- Gloves
- Heavy Boots
- Heavy socks
- Winter hat
- Scarf

## Where to Source

- Of course, our on-campus ReUse Room is totally free for students to use. There are often winter coats, hats, gloves, and scarves available for free.
- Local second-hand clothing stores like the Bargain Hut or Goodwill are great places to find warm layers at really low prices.
- Solstice Outdoors – is a locally owned “outdoorsy” gear shop on the lake. Think down jackets and Darn Tough wool socks.
- Moores on Main is army surplus – lots of students find quality flannels and boots there!
- For a more commercial option - L & M Fleet and Tractor supply both often have heavy winter boots and work clothes.

## So What's In the Dorms?

There are lots of great amenities in each residential hall for you to use. Below is a list of what will be available to you!

- Full kitchen with fridges, storage space, microwave and typically toasters
- Complete laundry facilities that are free to use
- Bike rentals are available in the bike shop and storage is available in most buildings
- Game closets are stocked with cards, board games, some outdoor games and more
- Full communal restrooms with shower areas, toilet areas, sinks, and hand dryers
- Lounges with TV's are located in each building
- The Bay Area Rural Transit (Bart bus) stops on campus and is free for students to use

# Opening a Bank Account

## Banking

If you do not plan to have all your work study earnings go directly on your Northland account, it is recommended, although not required, to open a local bank account. This greatly simplifies the process of accessing your money whether you choose to have earnings direct deposited or if you like to bring your checks to the bank in person.

The two most popular banks for international students studying at Northland are Associated Bank (we have their ATM in the Ponzio Campus Center) and Superior Choice Credit Union.

To set up a bank account, go to the bank of your choice in person and bring the following materials:

- Passport
- Student ID card
- Social Security Card
- If you want to take out a credit card, you'll need to meet with a loan officer
- Proof of address: A letter addressed to you with your Northland address.

*Pro Tip: you can ask the city clerk or a library at the Vaughn Library to send you a letter.*

To close your bank account, you need to do this in person before leaving the area. The bank will require you provide a written notice of your intent to close your account. Once this is complete, they'll issue you a cashier's check.



# What to Pack and Not to Pack

---

Here are guidelines and helpful tips on what to pack for your first year on campus:

## Essential Items For Your Carry On

- Phone (So we can communicate with you once you arrive)
- Personal computer or laptop (PC with Windows 7 or higher/Mac with OS X 10.7 or higher)
- Outlet adapter: You can get a new charging block for most cords with micro-USB or USB-C plugs, but you'll need an adapter if you're bringing your own laptop
- Documents and IDs: Copy of all your important documents and store the copies separately from the originals. Leave an additional copy with someone in your home country and keep an electronic copy in a secure location.
- I-20 and receipt for SEVIS I-901 and all documents needed for border crossing
- Admissions and Enrollment Letter from Northland College
- Flight information and booking reference
- Passport
- International health insurance ID card
- Copy of your completed health forms, including records of immunizations and vaccinations
- Contact information for Northland College
- Medications: prescription and over the counter. Bring what you need, they tend to be very expensive in the US.

*Tip: We recommend packing a carry-on bag with a change of clothes and other items that you may need in your first few days in the United States. In some cases, lost luggage can take a few days to recover, so keep this in mind if there are things that you will need immediately*

## Don't Cross The Border With

- Undocumented drugs and medications
- Food (unpackaged food from animals or plants is not admissible into the US and you may receive a fine if you try to bring them). For more information, visit US Customs and Border Patrol.

- Illegally copied products (pirated music/movies, software, etc.)

## Essential Items in your Checked Luggage:

- Basic clothes and shoes
- Good outerwear: A basic coat and hat will be important. When it comes to full winter gear, our advice is to bring it if you have it but wait to get it here if you don't. The average daily high temperature in the winter in Ashland is 25 degrees Fahrenheit (-4 Celsius), so be sure to bring a few layers as it starts getting chilly in October.
- Health and hygiene items: toothbrush, toothpaste, deodorant, body wash, shampoo, Kleenex, hair products, Band-Aids, towels, washcloths, etc.
- Electronics: electrical converters and chargers for electronics Keep in mind: the voltage in the U.S. is 110 or 120 volts

## Recommended to Buy When You Arrive

- Preferred school supplies: Pens, pencils, highlighters, scissors, notebooks, flash drive, stapler, backpack, and anything else you need. Basic cleaning supplies:
- Broom, disinfectant wipes, etc. Shower shoes
- Decorations for your room:
- Plants, rugs, posters, pictures, etc.
- Tape for hanging decorations
- Power strip where you can turn everything off
- Fan (window or standing)
- Headphones
- Spoon/fork/plate/bowl: many campus events ask students to bring their own utensils
- Mug: Get a discount in the school store for bringing your own when you get coffee, tea, or hot chocolate!
- Water bottle
- Things for fun: Frisbee, playing cards, hammock, gaming console, bike, etc.



# Academic Calendar 2023-24

---

## Fall Semester

- Mon, Sept 4 - Labor Day, residence halls open for returning students (8 am)
- Tue, Sept 5 - Last day to add courses online (midnight)
- Wed, Sept 6 - Fall term begins
- Fri, Sept 15- Last day to add courses with faculty approval (4 pm)
- Fri, Sept 15 - Last day to drop courses without record (4 pm)
- Tue, Sept 19 - Fall census (12 noon)
- Mon, Oct 16 - Mid-Session Reading Day (no classes)
- Fri, Oct 20 - Mid-term grades due (4 pm)
- Mon, Oct 23 - Due date for prior winter term incomplete grades
- Fri, Nov 3 - Last day to withdraw from a course with a "W" grade
- Mon, Nov 6 - Registration begins for Winter and May terms
- Sat, Nov 18 - Thanksgiving break begins
- Mon, Nov 27 - Due date for prior May term incomplete grades
- Mon, Nov 27 - Classes resume
- Fri, Dec 15 - Last day of fall term
- Fri, Dec 15 - Residence halls close (7 pm)
- Mon, Dec 18 - Final grades due (4 pm)

